

*EAC*

HEARTLAND LIVESTOCK SERVICES

GEOLOGY OF THE GRENFELL FEEDLOT AREA

Report 0164-005

June 3, 1998

1

2

3

4

5

6

7

8

9

10

11

12

13

14

15

16

17

18

19

20

21

22

23

24

25

26

27

28

29

30

31

32

33

*E. A. Christiansen Consulting Ltd.*

CONSULTING GEOLOGIST

BOX 3087  
SASKATOON, SASKATCHEWAN, CANADA  
S7K 3S9

PHONE 374-6700

June 3, 1998

Saskatchewan Wheat Pool  
201 - 407 Downey Road  
Saskatoon, Saskatchewan

Attention: Mr. Neil Ketilson

Re: Geology of the Grenfell feedlot area

Dear Mr. Ketilson:

Enclosed please find two copies of the "Geology of the Grenfell feedlot area", one copy for you and one for Les Henry. If additional copies are required, please contact me.

Sincerely yours,

  
\_\_\_\_\_  
E.A. Christiansen, P. Eng., P. Geol.



ASSOCIATION OF PROFESSIONAL ENGINEERS OF SASKATCHEWAN		
<b>CERTIFICATE OF AUTHORIZATION</b>		
E.A. CHRISTIANSEN CONSULTING LTD.		
NUMBER		<b>505</b>
PERMISSION TO CONSULT HELD BY:		
DISCIPLINE	SASK. REG. No.	SIGNATURE
<i>Geology</i>		<i>E.A.</i>

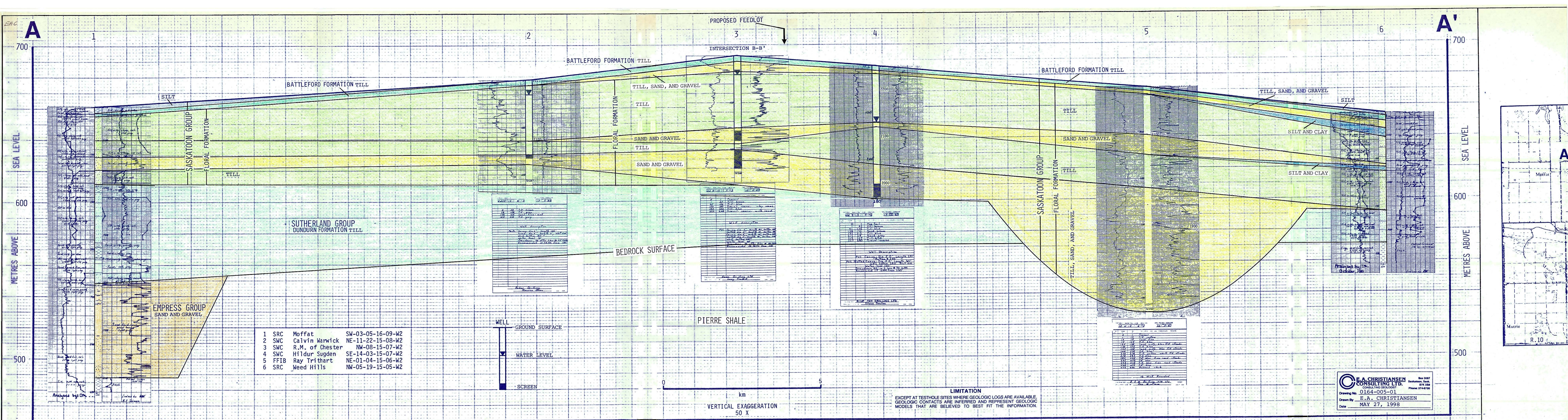

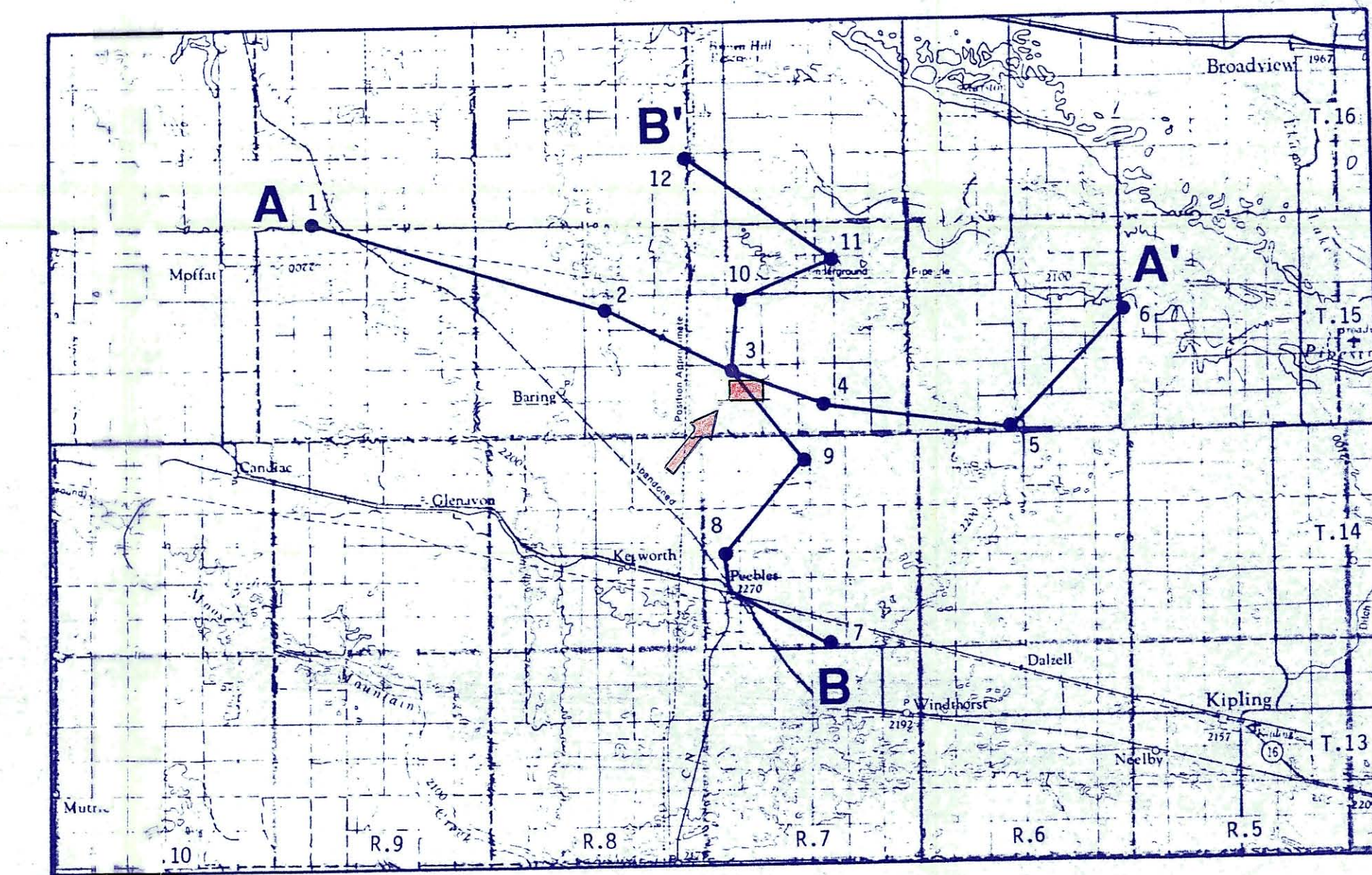

ARROW POINTS TO PROPOSED GRENFELL FEEDLOT SITE

DRAWING 0164-005-02. CROSS SECTION B-B' OF THE GRENFELL FEEDLOT SHOWING  
A PRELIMINARY ASSESSMENT OF THE GEOLOGY OF THE SITE